

# White extra-flat cabinet speaker pair | 0609.04

## Advice for assembly and positioning

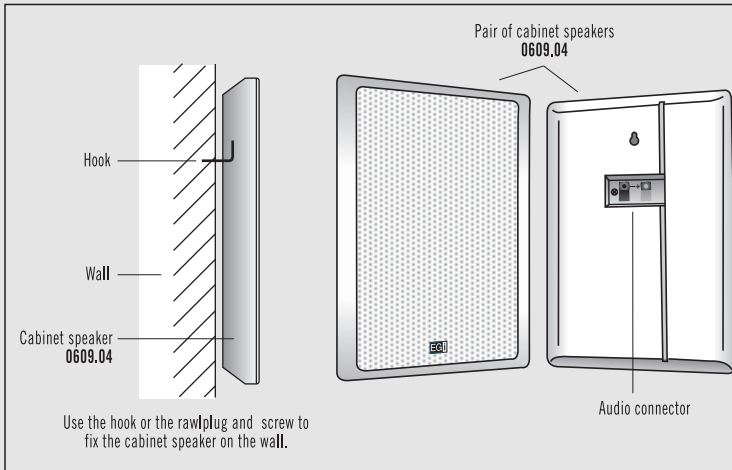

- This extra-flat cabinet speaker of ref. 0609.04 is ideal for walls or other areas, where surface conditions do not allow in-wall devices but it is possible to hang them using hooks, rawplugs, screws and other fixing means.
- Thanks to its extra-flat form, we obtain a cabinet speaker with very small thickness, allowing us to hang it on any wall. It blends easily into any décor and can be appropriately integrated in any decoration, especially when design and style are particularly important.
- Another important characteristic of this cabinet speaker is the sonority and the frequency response that it produces, lowering the frequency range to 130 Hz with a minimum total volume of 1,8 litre, using 5" speaker for low mids and a tweeter for trebles.
- For its ideal configuration and to complete a Hi-Fi system, we recommend combining Scenic subwoofer (ref. 6607.08) with 10-20 minimum amplifier power of Domos boosters (ref. E17G) or Millennium amplifiers (refs. 1311.1, 1303.1, 1304.1, 1309.1 & 1310.1); up to a maximum power of 160W of EGi output power stages (ref. 6301). Some examples of connection diagrams are shown below.

## Stereo connection

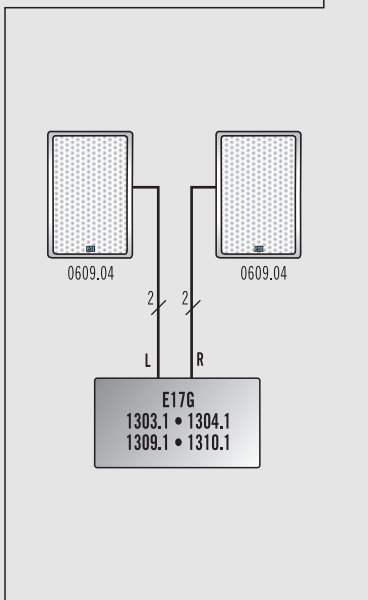

## Mono/bridge connection

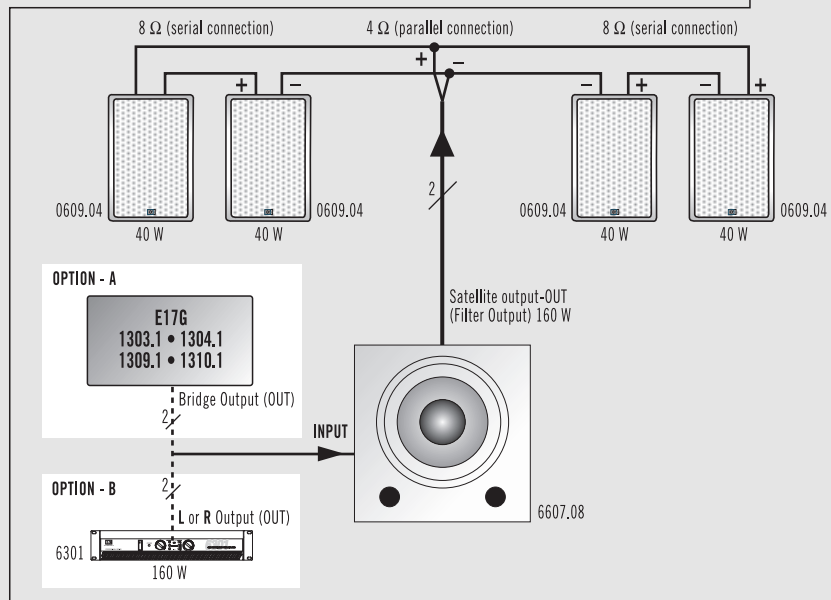

## Frequency response curve

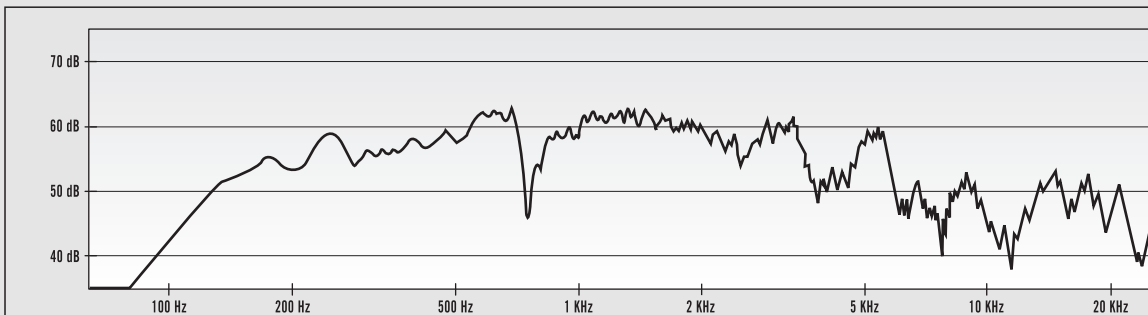

Adjusted average of samples made with spectrum analyser Brüel & Kjael® (Brüel & Kjael is a registered trademark).

TECHNICAL SPECIFICATIONS	0609.04	TECHNICAL SPECIFICATIONS	0609.04
N° of ways	2 (5" and 1")	Impedance	4 Ω
Covering angle (horizontal)	30° @ 4 KHz; 104° @ 2 KHz	Cabinet speaker type	Compression driver (closed box)
Frequency response (+/- 6dB)	130 Hz - 18 KHz	Colour	White
Power	40 W rms	Dimensions (mm)	185 x 275 x 38
Sensitivity @ (1 W/1 m) 128 Hz—12.8 KHz	85 dB	Weight/Unit (kg)	1